

SIMPLE SAVER SYSTEM®: EFFECTS OF INSTALLATION ON METHODS OF INSULATING METAL BUILDINGS

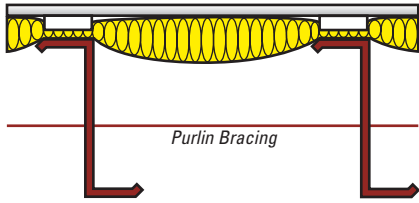

Values in orange were tested at Oak Ridge National Laboratory in Fall 2006. All other values calculated by NAIMA and published in 7/91 Metal Construction News.
*Average purlin spacing is always less than 5 feet.



METHOD 1
Laminated "Over-the-Purlin" Method

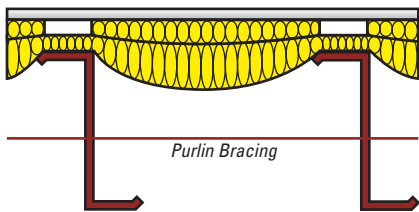
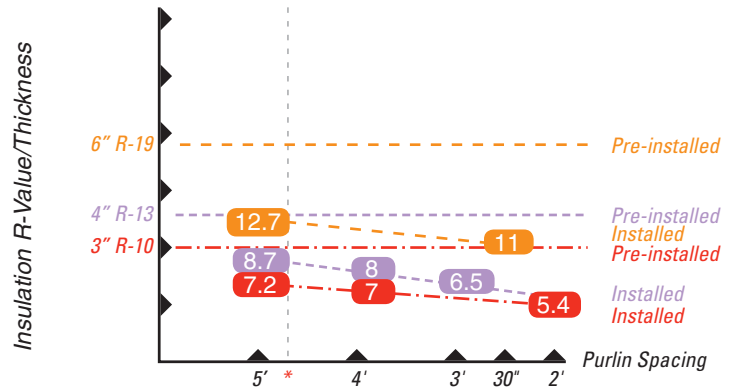

METHOD 2
Laminated "Sag-n-Bag" Method
(without supplemental support straps)

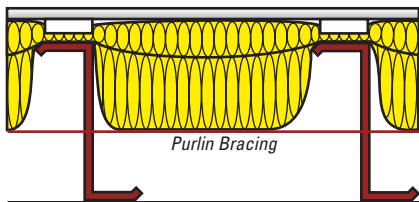
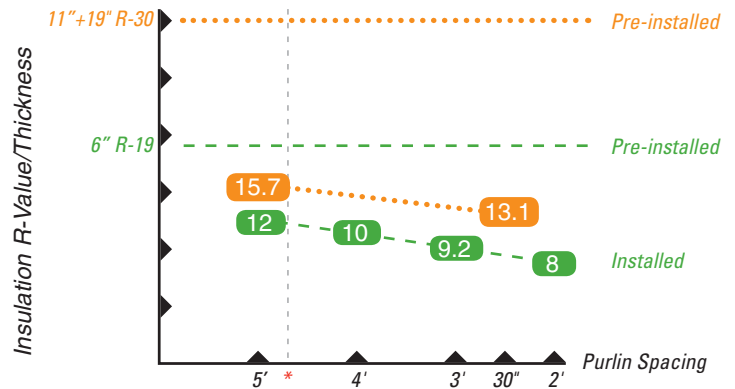

METHOD 3
Laminated Insulation with Long Tabs
(with supplemental support straps)

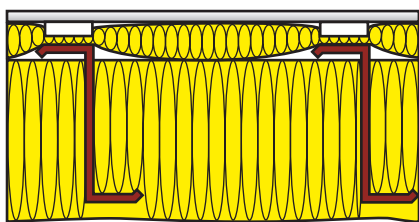
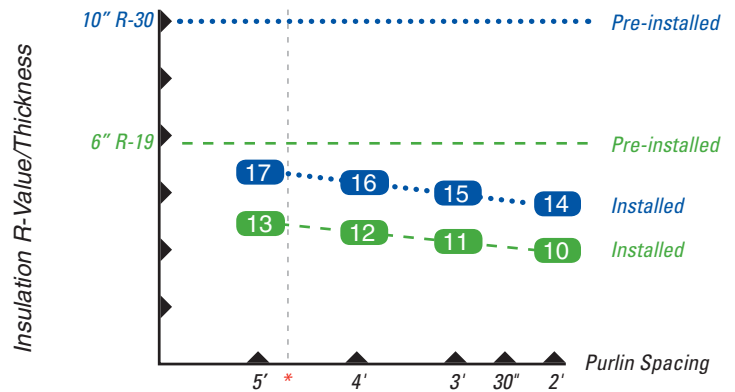

SIMPLE SAVER SYSTEM®
Insulating Liner Under Purlins
Call Thermal Design at 800-255-0776
for all your insulation quotes!

