

# Purlin Spacing and Brace Request

## Notice to our pre-engineered metal building manufacturer:

In order to improve productivity rates and reduce material waste, please default all typical purlin spaces to the widths listed in the table to match standard insulation widths. Today's energy codes and fuel costs require the use of thick, uncompressed insulation systems that fit between the roof purlins. Non-standard purlin spaces cause significant and unnecessary time and material waste required to cut wider rolls to fit between the purlins. Standardizing the purlin spacing to match standard widths of fiberglass insulation blanket will minimize waste and dramatically improve the quality and thermal performance. Ideal purlin spacings would be one inch narrower than the insulation widths for a tight fit when there is a slight bow in the purlins.

Standard Fiberglass Widths	Default Purlin Spacings
72"	69" to 72"
60"	57" to 60"
48"	45" to 48"
36"	33" to 36"
30"	27" to 30"
24"	21" to 24"

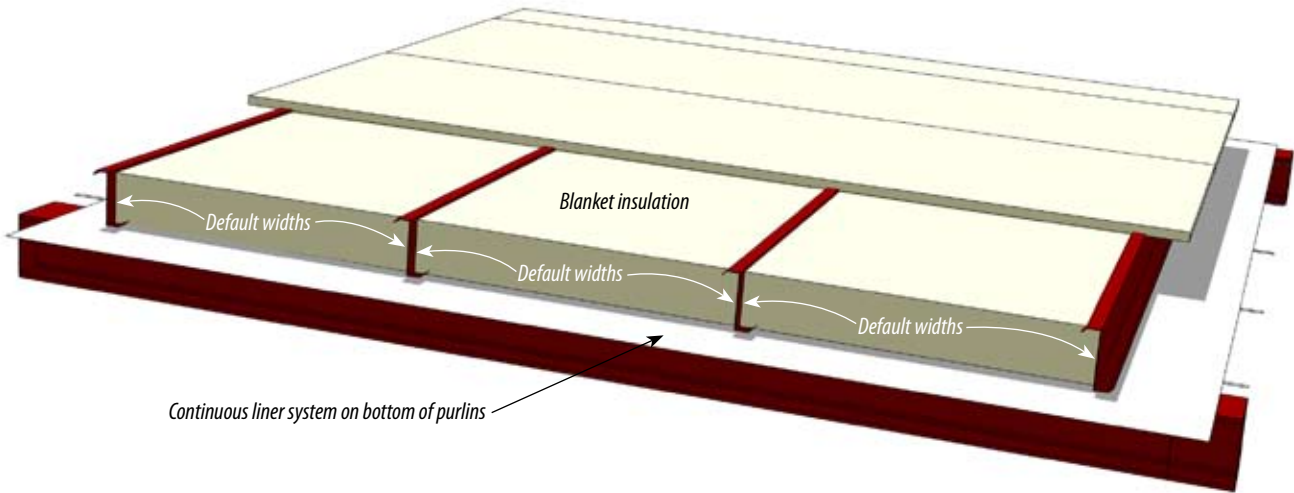

Rafter brace attachments to the purlins can also be time consuming to work with. Bolting braces to the side of the purlins must penetrate the ceiling liner and are difficult to seal. Most manufacturers provide one of the following options. Please adopt and approve for use one of the following details for use with this project.

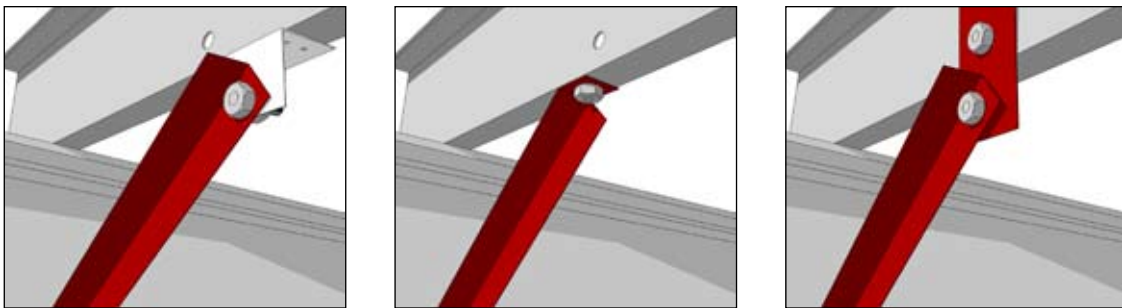

**Several Brace Clip Options**

Thank you for your time and consideration.

Contractor \_\_\_\_\_ Date \_\_\_\_\_

Project Name \_\_\_\_\_